

Aligning your aerial

Turn on your TV set. Refer to manufacturers instructions to tune your TV into the available digital/HD/3D channels. Select a tuned-in channel. Next, carry out the following procedures:

1. Turn your aerial to the LEFT until you lose the picture (if alone turn the volume up and turn until you hear a reduction in sound quality).
2. Remember this position and turn your aerial to the RIGHT until you lose the picture/sound again.
3. Now point the aerial in the centre of these two points and you will receive optimum reception.

Digital & HD reception:

Reception of digital terrestrial TV (DTT) signals is subject to:

1. Use with a DTT set top box or integrated TV with digital tuner/receiver
2. Satisfactory signal quality from DTT transmitter

To receive terrestrial HD channels you will require the following:

1. An HD ready TV
2. Freeview HD receiver or TV with integrated Freeview HD tuner/receiver
3. HD signals must be transmitted in your local area. Visit www.freeview.co.uk for more information.

Safety warnings:

- > Before starting installation check structure is sound and check for hidden electrical wiring or plumbing.
- > When working on installations outside, beware of overhead power lines.
- > Observe safe working practices, tread carefully and ensure adequate lighting is available in loft/roof space.
- > Always follow manufacturer's operating and safety instructions before using tools and/or equipment.
- > Ladder safety - always read and follow the manufacturer's instruction label affixed to the ladder.
- > Ensure cable is correctly routed before fixing into position, taking care not to over tighten cable clips.
- > This product may contain small parts - keep out of reach of children.
- > After installation make regular maintenance checks.
- > If in doubt consult a qualified or professional aerial installer.

MAXVIEW

Assembly instructions

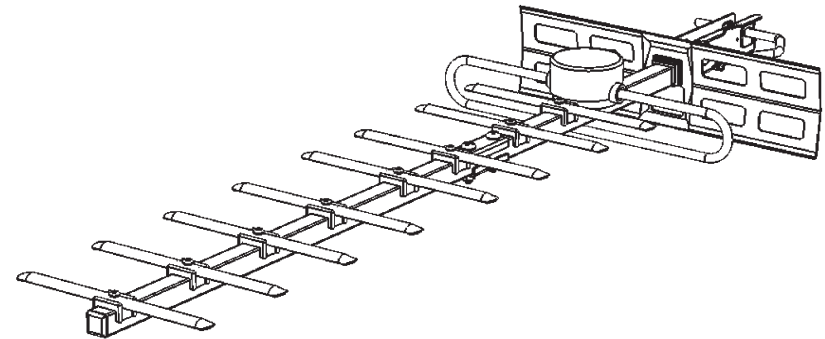

Model:

MXR0010 TV Aerial - 14 Element

Contact:

Helpline: +44 (0)1553 811000
Email: support@maxview.co.uk
Web: www.maxview.co.uk

Maxview reserve the right to change specifications without prior notice
9111303 Iss 3

Pack contents check

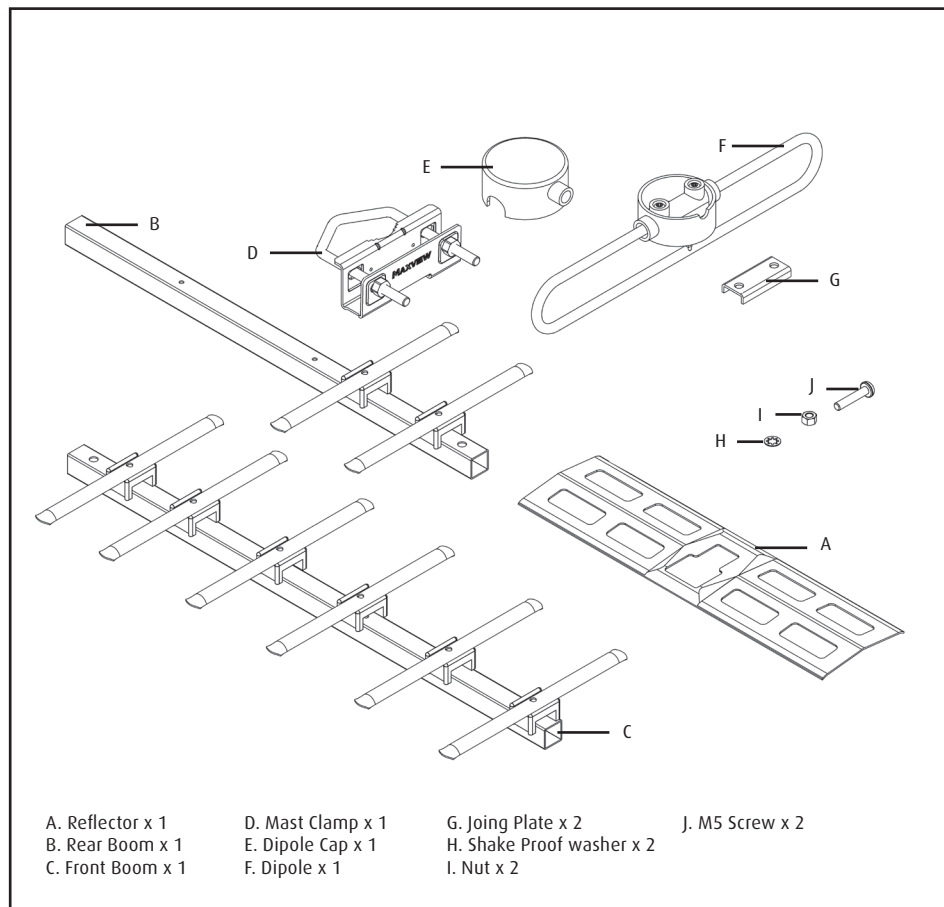

Assembly

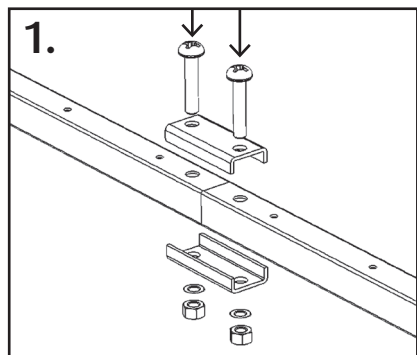

Join the 2 pieces of boom together using the joining plate, M5 x 20mm screws M5 nuts and 5mm Shake Proof Washers.

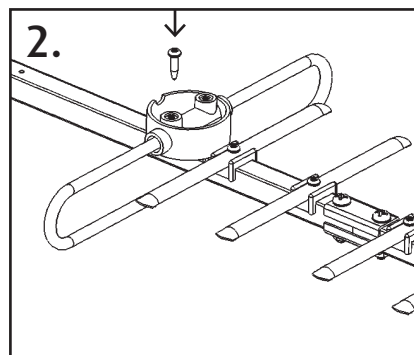

Screw on firmly the Dipole to the Boom.

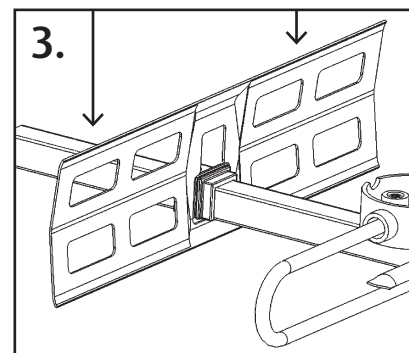

Slide on and firmly push down the Reflector onto the groove of the Reflector Bung.

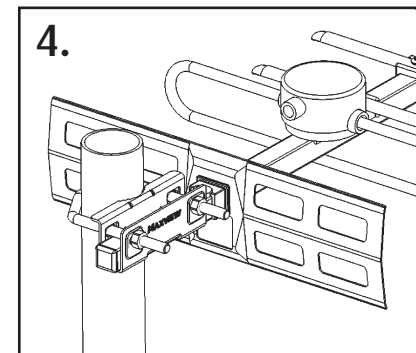

Attach aerial to a suitable mast using the supplied Mast Clamp. (Note: Mast not supplied).

Connecting Coaxial Cable (not supplied)

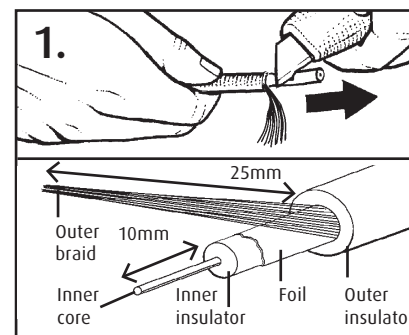

Thread coaxial cable through Dipole Cap. Strip away 25mm of outer insulator. Gather outer braid strands and twist together. Remove 10mm of inner insulation around inner core.

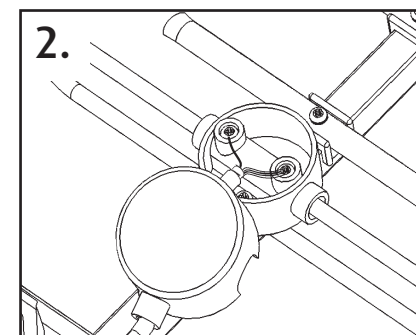

Loosen the screws on the 2 terminals in the Dipole. Feed the inner core to one of the terminals and the twisted braid into the other. Tighten screws and close Dipole Cap.

Polarisation

Tip: Look at outdoor aerials in your area to see which direction to point your aerial for best reception.

Note model shown different. For example only.

