

alphatronics



powered by
webOS Hub

User manual

For all alphatronics TV sets with webOS Hub operating system



CONTENT

1. Introduction	4
2. Our quality promise	4
3. New operating system webOS Hub	5
4. Intended use.....	5
5. General safety instructions	6
5.1 General notes	6
5.2 Notes on transport	6
5.3 Notes on assembly	7
5.4 Notes on the power supply.....	8
5.5 Notes on the remote control and batteries	9
6. Scope of delivery	9
7. Product in detail.....	10
7.1 Connection overview.....	10
7.2 Remote controls	11
7.2.1 Normal version.....	11
7.2.2 Magic remote control.....	12
7.2.3 Inserting the batteries.....	14
8. Initial set-up of the TV set	14
8.1 Wall mounting with VESA bracket.....	14
8.2 Mounting the stand	15
8.3 Commissioning.....	15
9. Homescreen.....	26
9.1 Digital user guide	27
10. Reception	27
10.1 DVB-S2 (Satellite) Setup.....	28
10.2 Setting up DVB-T2 (antenna).....	30
10.3 Switching between reception modes.....	31

10.4 Programme Guide, Channels, TV Planner.....	32
10.5 Transmitter sorting	33
10.5.1 Channel sorting on the TV	33
10.5.2 Station sorting via ChanSort.....	34
10.5.3 Exporting / importing channel lists	34
10.6 HbbTV	35
10.7 Displaying the CI+ information.....	35
11. Integrated DVD player (depending on model).....	36
12. Multimedia functions.....	37
12.1 HDMI CEC function.....	37
12.2 Using HDMI ARC.....	37
12.3 Connecting Bluetooth® output devices	37
12.4 Multimedia player.....	38
12.5 Web browser	38
12.6 Connecting external peripherals.....	38
13. General functions	39
13.1 Updates.....	39
13.2 Settings.....	39
13.3 Resetting the machine	40
13.4 Quick Access.....	40
13.5 ThinQ App.....	41
13.6 Content Store.....	42
13.7 Sharing the smartphone screen.....	42
13.8 Connecting the Windows PC (wirelessly) to the TV set	42
14. Technical data.....	42
15. Cleaning.....	44
16. Legal information.....	44

1. INTRODUCTION

Thank you for choosing an alphatronics product and placing your trust in us. Our products are specially developed for the needs of the mobile world and stand for reliable quality that you can trust.

These operating instructions are intended to help you handle and operate the product. Therefore, please read the operating instructions carefully.

Keep the instructions for the entire life of the product and pass them on to subsequent users or owners. Please check the package contents for completeness and ensure that no faulty or damaged parts are included!

2. OUR QUALITY PROMISE

Focus on quality as well as the optimal conditions for the use of our devices in the vehicle are our highest goal, true to our guiding principle "greatness in detail".

To achieve this goal, we place particular emphasis on the following parameters:

Made in Germany - All our TV sets are assembled and tested in Nuremberg.

Over 20 years of experience - In addition to innovation, the experience gained from the mobile world is an important companion in the development and further development of our TV sets.

Focus on safety - Safety aspects such as voltage stability, reverse polarity protection or even special corrosion protection guarantee a high longevity of our devices even over several years.

Tested thoroughly - In addition to the legal requirements, we regularly subject our TV sets to vibration and climate tests. This is to ensure function even under extreme conditions (e.g. at the North Cape in sub-zero temperatures or in the desert in extreme heat).

Pixel class 0 - Because an optimal image is important to us, every panel is tested and delivered to be 100% pixel-free.

Sophisticated technology - Special wide-angle displays, CIS screen technology, external antennas as well as efficient power consumption have a special significance in our development and make the difference.

3. NEW OPERATING SYSTEM WEBOS HUB

In this TV generation, we rely on the licensed operating system webOS Hub.

This offers us the opportunity to further develop our existing technology and features in terms of intuitive usability. Here, an operating system known from the home area and loved by many is combined with the requirements of the mobile application. Another advantage of the operating system is the continuous further development and the constant addition of further functions via OTA updates (WLAN).

Through licensing with the streaming platforms (Netflix, Amazon Prime, YouTube, Disney+ or Apple TV), we can guarantee smooth as well as direct access to your films and series (just like at home) even when you are on the move.

4. INTENDED USE

This unit is intended exclusively for the reception and playback of picture and sound signals. For this purpose, the unit has a built-in triple tuner and a WLAN & Bluetooth® interface for playing media content from installed apps or the Internet.

It must not be operated in rooms with high humidity (e.g. bathroom or sauna). If the unit is used outdoors, ensure that it is protected from moisture (rain, dripping & splashing water). High humidity can lead to leakage currents in the unit. This in turn can lead to the risk of contact with voltages or a fire.

If you have brought the unit out of the cold into a warm environment, leave it switched off for about one hour because of the possible formation of condensation moisture.

The warranty is only granted for use in the specified permissible environment!

5. GENERAL SAFETY INSTRUCTIONS

For your own safety and to prevent unnecessary damage to your unit, please read and observe the following safety instructions:

5.1 General information

Important safety instructions!

- This product is intended for private, non-commercial use!
- This product, like all electronic products, does not belong in children's hands!
- This product is not intended to be used by persons (including children) with reduced physical, sensory or mental capabilities, or lack of experience and / or knowledge. Unless they are supervised by a person responsible for their safety or have received instructions from you on how to use the appliance!
- In any of the following cases, disconnect the mains plug immediately and contact your customer service or the service hotline:
 - If the unit has been subjected to extremely strong vibration!
 - If the unit has been damaged or if foreign objects have entered the unit!
 - If smoke or unusual odours emanate from the unit!
- Do not disassemble the product into its individual parts. The unit does not contain any user-serviceable components. Improper assembly may result in electric shocks or malfunctions!
- Never open the unit! Any attempt at repair by unqualified persons can be dangerous!
- Do not make any modifications to the product, as this will invalidate any warranty claims!
- Do not place any objects filled with liquid or naked flames (fire) on the appliance!

5.2 Notes on transport

Important safety instructions!

Only touch the unit by the edges of the housing! The display is made of glass or plastic and may break or be damaged if handled improperly. No guarantee will be given for damage caused by external influences!

- Avoid touching the screen or pressing on the screen or frame with your fingers for a long time. This may cause temporary distortion effects or damage to the screen!
- Do not exert strong pressure on the unit display with your hand or a pointed object such as a nail, pencil or biro!
- It is recommended that the TV set be moved or transported in its original box or packaging (if it has not been permanently mounted).

5.3 Notes on assembly

Important safety instructions!

The ventilation slots on the rear panel of the set must always be kept clear. Please do not place any foreign objects, e.g. newspapers, doilies or other textiles on or over the TV set. Ensure that there is at least 2 cm of free space at the sides and top for air circulation.

If the unit is installed or mounted in a cabinet or on a shelf, it is imperative to ensure that air circulation can take place sufficiently. Like any electronic device, the product needs air for cooling during operation. If the air circulation is obstructed, fires or an automatic shutdown (protective shutdown) of the unit may occur.

- Protect the unit from dusty environments!
- If the TV set is mounted on the wall, it must not be suspended from the power and signal cables on the back of the TV set. Otherwise there is a risk of fire or electric shock!
- Make sure that children do not hang onto or climb up the TV set. Otherwise, the set may fall over, causing serious injuries!
- If you mount the TV set on the wall, attach a VESA wall bracket (optionally available) to the back of the set! If you want to mount the TV set with a wall bracket, attach it carefully to prevent it from falling down!
- Do not place the product on unstable shelves or inclined surfaces! Also avoid locations that vibrate or on which the product does not have a secure hold! Otherwise, the unit may fall down or over, causing injury or damage to the unit!
- The unit should not protrude forwards, especially when placed in or on furniture!
- Do not touch the ventilation openings when the TV set is running for a long time, as the ventilation openings could become hot!

5.4 Notes on the power supply

Important safety instructions!

Incorrect voltages can damage the unit! This unit may only be connected to a power supply network with the voltage specified on the type plate using the correct 12V/24V unit connection cable!

Always lay the power cable so that it cannot be damaged! The power cable must not be bent, laid over sharp edges, walked on or exposed to chemicals! A power cable with damaged insulation can cause electric shocks and is a fire hazard!

Additional notes - External 230V power supply unit (optional)

- When using the product in combination with a 230V power supply, make sure that it is always easily accessible. To be able to remove it quickly from the socket in an emergency!
- Do not touch the mains plug with wet hands! If the contact pins are wet or dusty, dry the mains plug completely or remove dust. Moisture increases the risk of fatal electric shock!
- The power cable must be fully plugged into the socket! If the power cable is not firmly plugged into the socket, there is a risk of fire!
- Do not touch the end of the mains cable with a conductive object (such as a fork) while the mains cable is connected to the socket!
- No metal objects such as coins, hairpins, cutlery or wire or flammable objects such as paper or matches may get into the unit! Pay particular attention to children. There is a risk of electric shock, fire or injury! If an object gets into the unit, unplug the power cable and contact customer service!
- The power cable must not come into contact with hot objects such as a radiator! Also, do not place any heavy objects or the unit itself on the power cable! Otherwise there is a risk of fire and electric shock!
- Do not connect too many electrical appliances to a single socket! Otherwise, fires may occur due to overheating!

5.5 Notes on the remote control and batteries

Attention! Laser class 1

The remote control has an infrared diode of laser class 1. Do not look at it with optical devices to avoid eye injuries!

- There should be no objects between the remote control and the IR sensor.
- The signal from the remote control can be disturbed by sunlight or other strong light.

Important safety instructions!

- Always store batteries so that they are safe for children! There is a danger of swallowing!
- Never try to charge alkaline batteries!
- Do not short-circuit batteries or throw them into a fire!
- Always replace both batteries at the same time! Do not mix old and new batteries or batteries of different types!
- Battery acid leaking from a battery can cause skin irritation! In case of skin contact, rinse with plenty of water. If the liquid has got into the eyes, rinse thoroughly with water, do not rub and consult a doctor immediately.

6. SCOPE OF DELIVERY

- TV set
- Remote control (Normal or Magic remote control - depending on model)
- Pedestal
- 12V connection cable with cigarette lighter
- Mounting screws & other accessories
- Operating instructions

Note! Depending on the dealer or sales region, additional accessories may be included. The description of the scope of delivery always refers to the standard version. 32" and 40" models are delivered without a stand as standard.

7. PRODUCT IN DETAIL

7.1 Connection overview

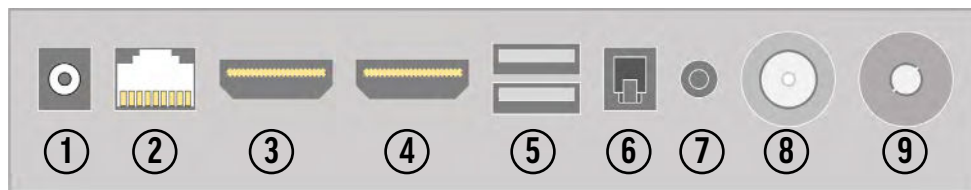

- ① Power connection (input voltage: 9.0 - 32 V DC)
- ② RJ45 socket (LAN connection)
- ③ HDMI™ [Port 2] with CEC and ARC/eARC Support
- ④ HDMI™ [Port 1] with CEC Support
- ⑤ 2x USB 2.0 port
- ⑥ SPIDF / Toslink connection (digital sound output)
- ⑦ 3.5 mm jack connection (headphones)
- ⑧ F socket (SAT connection)
- ⑨ IEC socket (antenna / cable connection)

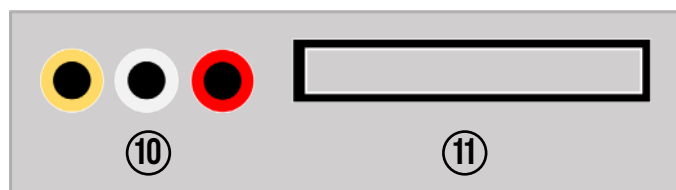

- ⑩ Cinch sockets (AV input)
- ⑪ CI+ slot (cards and module are additionally required!)

i Information - HDMI™ ARC and HDMI™ CEC

ARC - ARC (Audio Return Channel) is a digital channel that TVs use to send audio to a soundbar or AV receiver via an HDMI™ cable. It doesn't matter if the audio signal comes from a built-in TV tuner, an external streaming box or a game console.

CEC - Stands for Consumer Electronics Control and enables both the control of several devices connected via HDMI™ with only one remote control and the coupling of certain functions (e.g. switching on all devices together). Depending on the manufacturer, this function may be known differently.

7.2 Remote controls

Depending on the model line or the purchased SET, one of the following remote controls is included. The Magic remote control can be retrofitted at any time on models that are delivered with the normal version. Please contact your dealer or visit our spare parts shop at www.alphatronics.de.

7.2.1 Normal execution



1. **[POWER]** - Switch on/off
2. **[TV/RAD]** - Switching between TV and radio mode
3. **[LENS]** - Search function
4. **[SUBTITLE]** - Enable the subtitles
5. **[⚙️]** - Open the settings
6. **[📺]** - Source selection
7. **[NUMBER KEY PAD]** - Digits 0-9
8. **[LIST]** - Open the Programme Guide, Channels, TV Planner
9. **[⋮]** - Open further functions (actions)
10. **[🔊]** - Volume +/-
11. **[📺]** - Programme +/-
12. **[AD]** - Enable / disable audio description
13. **[GUIDE]** - Opening the Programme Guide
14. **[🔇]** - Mute
15. **[PLAY]** - Start playback
16. **[🏠]** - Open the Home menu
17. **[PAUSE]** - Pausing the playback
18. **[BACK]** - Back to the last level
19. **[EXIT]** - Close menu / window
20. **[NAVIGATION KEYS] + [ENTER]** - Select and confirm
21. **[TEXT]** - Opening the teletext
22. **[T. OPT]** - Other Teletext Options
23. **[MOVIES]** - Opening the Movie Library
24. **[STOP]** - Stop playback
25. **[NETFLIX] + [PRIME VIDEO]** - Shortcuts
26. **[COLORED BUTTONS]** - Advanced Settings / HbbTV
27. **[REC]** - No function

i Information - Audio description

Audio description makes it possible to make video content comprehensible for blind and severely visually impaired viewers. For audio description, a narrator describes what can be seen in the picture, such as important information about the plot, people or locations. Text overlays are also read aloud (however, this function and the extent depends on the programme).

7.2.2 Magic Remote Control



integrated AirMouse
and voice control

1. **[POWER]** - Switching on/off
2. **[]** - Switching on/off an external set-top box
3. **[NUMBER KEY PAD]** - Digits 0-9
4. **[-/LIST]** - Open the programme guide, channel, TV planner.
5. **[...]** - Opening further functions (actions)
6. **[< >]** - Volume +/-
7. **[M]** - Mute
8. **[V]** - Voice command
9. **[+/-]** - Programme +/-
10. **[HOME]** - Opening the Home Screen
11. **[G]** - Opening the settings
12. **[NAVIGATION KEYS]** - Navigation up/down/left/right
13. **[WHEEL / ENTER]** - Scrolling and confirmation of selection
14. **[←]** - Back button
15. **[GUIDE]** - Opening the Programme Guide
16. **[S]** - Source selection
17. **[NETFLIX] + [PRIME VIDEO]** - Shortcuts
18. **[COLORED BUTTONS]** - Advanced Settings / HbbTV
19. **[MOVIES]** - Opening the Movie Library
20. **[PLAY]** - Start playback
21. **[PAUSE]** - Pausing the playback

Connecting the remote control

The Magic remote control is a remote control with infrared and Bluetooth® interface, so unlike the normal remote control, it must be tuned in to the TV set.

Variant 1 - Within the initial installation

As mentioned in step 2 in the initial installation (chapter 8.3 - step 2), point the remote control with the batteries inserted at the TV set for about **15-20 seconds and press the scroll wheel [ENTER]**. The remote control is then automatically registered on the set.

Variant 2 - Teaching in normal operation

To register the Magic Remote Control with your set, point it at the TV set while it is in operation and **press and hold the [GUIDE] key for about 20 seconds**. After a short time, a message will appear on the television confirming the registration.

This procedure also works if the remote control was previously tuned in to another TV set and you want to reconnect it or otherwise.

Activating the Air Mouse

The Magic remote control has an integrated air mouse function. A digital mouse pointer is displayed, which is intended to simplify the input of texts or the selection of certain points.

This can be activated in two ways:

Point the remote control at the TV set and move it slightly from left to right (shake) until the mouse pointer appears **or** press the scroll wheel on the remote control when it is pointed at the TV set.

Hint! The mouse pointer automatically disappears again if there is no movement or if another button on the remote control has been pressed.

If the mouse pointer does not respond smoothly, you can reset the mouse pointer by moving it to the edge of the screen.

Voice control

The Magic remote control has an integrated microphone that can be used for voice control. To activate the microphone, **press and hold the [M] key**. Then, **while holding down the button**, you can speak the corresponding voice commands or keywords into it for your search like "What's the weather like today in Nuremberg" or "Open *Friends* on Amazon Prime".

Tip! Make sure that the correct country language is set to avoid possible errors in interpreting the language. The menu language must correspond to the spoken language.

To achieve the best possible recognition of your speech, words must be spoken slowly and accurately, at an appropriate voice volume, at a distance of about 10 cm from the microphone of the Magic Remote.

7.2.3 Inserting the batteries

To do this, open the battery cover on the back of the remote control (push the cover of the battery compartment downwards with light pressure). Now insert the batteries according to the polarity stamped in the battery compartment and close the battery compartment again.

Standard variant: 2x AAA I Micro I Type LR03

Magic remote control: 2x AA I Mignon I type LR06

Recommendation! If the product is not used for a longer period of time, please remove the batteries to avoid acid leakage in the battery compartment.

8. INITIAL SET-UP OF THE TV SET

8.1 Wall mounting with VESA bracket

If the unit is to be permanently mounted in a vehicle or on a wall, please only do so using an appropriate VESA mount. For this purpose, the unit has standardised mounting points on the back according to the following table:

Unit size	VESA standard	Screws
19", 22", 24", 27"	100 x 100	M4
32"	100 x 200	M6
40"	200 x 200	M6

Always use 4 screws with the appropriate thread for mounting! When mounting, make sure that the unit is securely fixed to the wall bracket. The screw length depends on the wall mounting. Be sure to use screws of the correct length. Do not overtighten the screws as this could cause damage to the TV set!

8.2 Mounting the stand

As an alternative to mounting on the wall or in the vehicle, the TV set can also be mounted on a stand. Appropriate mounting screws are included for this purpose. When mounting the stand, make sure that the screws are not tightened too much! Also make sure that no fingers or objects are between the two components during installation! Otherwise there is a risk of crushing! You will need a Phillips screwdriver to assemble the screws.

8.3 Commissioning

i Information - Installation Wizard

When the TV set is connected to the mains for the very first time and switched on, it automatically starts with the installation assistant, which guides you through the individual steps. Each step is also explained on the screen.

Connecting the TV to the mains supply

Before the unit can be used for the first time, it must be connected to the mains supply in the vehicle. To do this, use the 12V connection cable supplied or a suitable alternative power cable. In addition, make sure that the on/off switch directly on the unit is set to **[ON]**.

Step 1 - Connection with the remote control

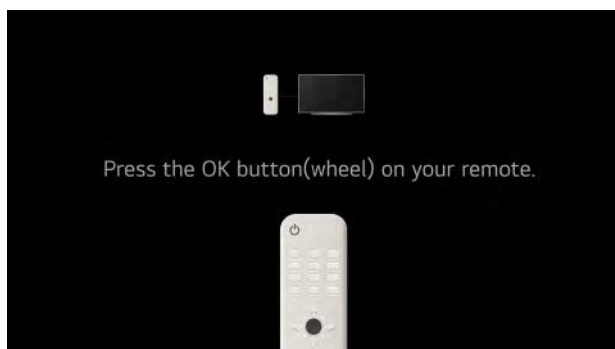

In this installation step, the enclosed remote control must be paired with the television. To do this, press the following button (red arrow) depending on the remote control model.



Normal execution



Magic Remote Control

Note: To teach the Magic Remote in this step, aim it at the TV set for about 20 seconds and press the scroll wheel [ENTER].

Step 2 - Selecting the installation method

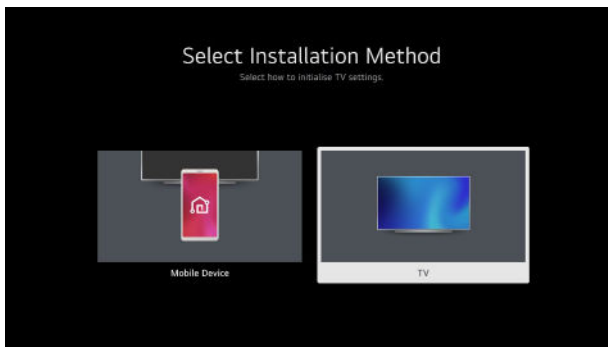

The TV set can be set up in two ways. Either via smartphone / tablet with the help of the LG "ThinQ" app (available for Android and Apple iOS) or directly on the TV set itself. The installation directly via the TV set is explained below.

Now use the navigation keys to select the [TV] window and confirm your selection with the [ENTER] key.

Step 3 - Setting the system language and the country

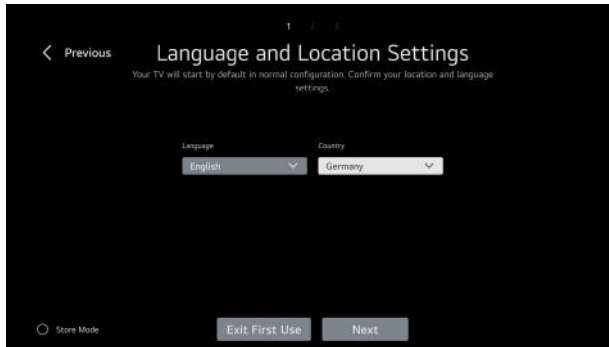

Select the desired language and the country in which the TV set is to be operated. This selection can be changed later at any time in the settings under *General > System > Language*.

Note: The country setting also changes the availability of some apps, which are only available via the Content Store on a country-specific basis.

i Information - Demo Mode

This setting (bottom left in the picture) can be neglected and is intended exclusively for trade partners who display the unit in the shop. In this case, a special demo mode is activated, which serves exclusively to present the functions of the unit.

If both the language and the country have been selected correctly, you can confirm this with the **[Next]** field to proceed to the next step.

Step 4 - Setting the Internet connection



As soon as this window has been opened, the TV set automatically searches for all available WLAN networks in the vicinity.

Select the desired network using the navigation keys and confirm your selection with the **[ENTER]** key. A new screen opens in which the password of the network can be entered. As soon as the network has been successfully added, the mask closes and the unit jumps to the next installation step.

If no WLAN network is currently available or the unit is to be operated exclusively offline, this step can also be skipped.

However, we advise you to **always** carry out the initial setup in connection with a WLAN network! This guarantees that the software and the app are up to date.

Step 5 - Confirm the terms and conditions

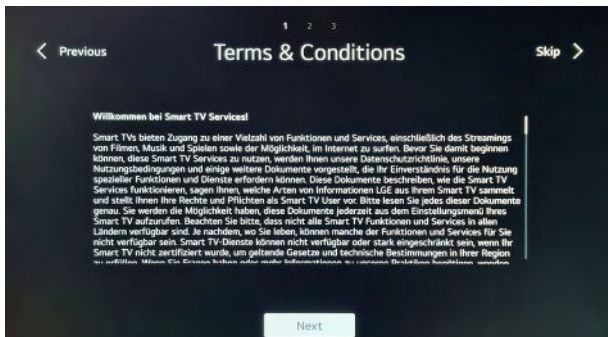

For the terms and conditions, the language displayed on the TV depends on where you are. Here it is in German because we took the screenshots in Nuremberg.

For the use of the device and its apps in connection with the Internet, the individual declarations must be accepted. Since our devices are based on the LG operating system (webOS Hub), the declarations are concluded with LG Electronics Inc. and not with alphatronics GmbH.

This consists of several parts:

- General Terms and Conditions for the Use of Smart Services
- Terms of use
- Transfer of information outside the EEA
- Television Usage Data Agreement
- Voice information
- Interest-based advertising (optional)

If these are rejected, the device cannot be connected to the Internet or used to its full extent! Therefore, read them in detail and accept them.

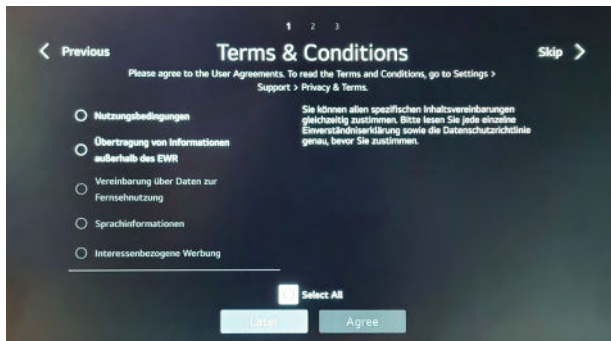

For the terms and conditions, the language displayed on the TV depends on where you are. Here it is in German because we took the screenshots in Nuremberg.

The **[Agree]** field takes you to the next step.

Step 6 - User analysis

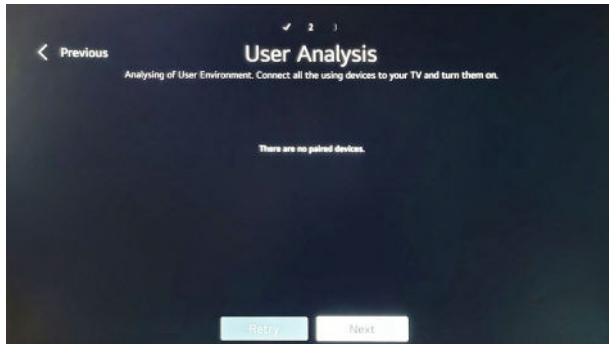

This step is used to configure further connected peripheral devices (e.g. consoles, smart sticks, etc.) If no further devices are connected, you can skip this step with **[Next]**.

Step 7 - Check settings

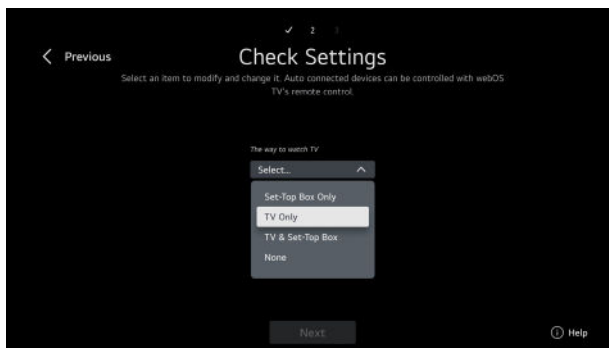

In this step you can set which devices are to be controlled via the remote control. If no other devices are connected to the TV, please select **TV only** here.

Step 8 - Type of assembly



In this step, select whether the unit was mounted on the stand or with a wall bracket. This setting adjusts the sound profile according to the mounting type.

Step 9 + Step 10 - Transmitter setting

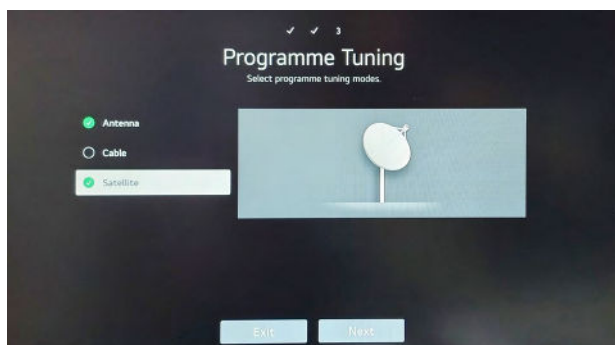

Here you can select the corresponding reception types to be used later (multiple selection possible). Select the desired reception types and then press the **[Next]** field.

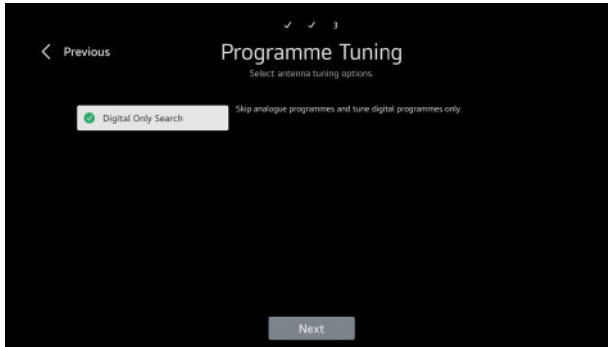

Now you can select whether only digital or also analogue channels are to be searched. Use the **[Next]** field to go to the next screen.

i Information

This field only appears if you have selected Antenna as the reception type. In 99 % of cases it is sufficient to search only for digital channels. In Germany and most other European countries, analogue television has already been completely switched off.

Step 11 - Selecting the satellite

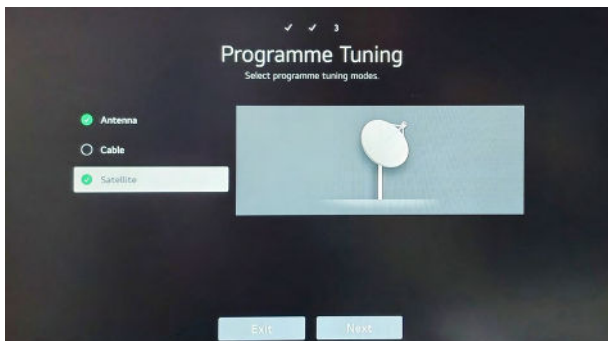

By entering the country beforehand, the system automatically suggests the most frequently used satellite of the country directly. If you would like to enter a different satellite, please select **[other providers]** and confirm with Next.

Adding other providers

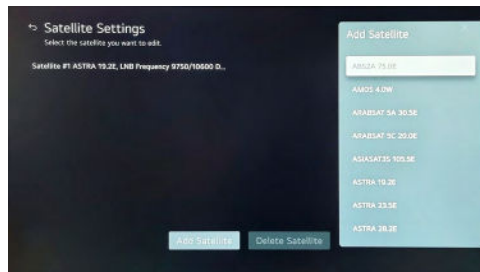
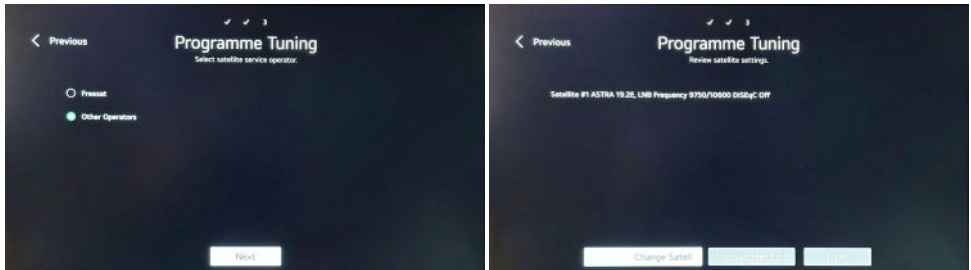

If you have selected **[Other provider]**, the following screen appears. Select the field **[Change satellite]** and add the desired satellite; a list of all available satellites is available.



You can then start the search with the **[Next]** field.

Step 12 - Search



The system now starts a search on all set reception sources.

Important! Especially when searching in the SAT range, it is imperative that the correct satellite is set. Otherwise the search will not start because the system compares both parameters with each other.

Wait for the search accordingly, as soon as the search is finished, the area **[Done]** appears.

Step 13 - LG Account

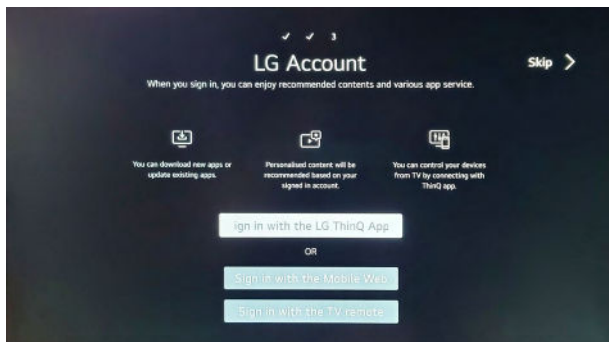

In order to be able to download apps from the Content Store, a corresponding user account must be created at LG. This can be done either directly on the TV set or in parallel via the smartphone/tablet.

Step 14 - The initial setup is complete

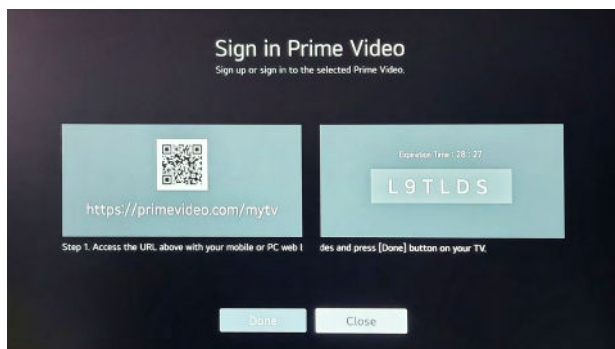
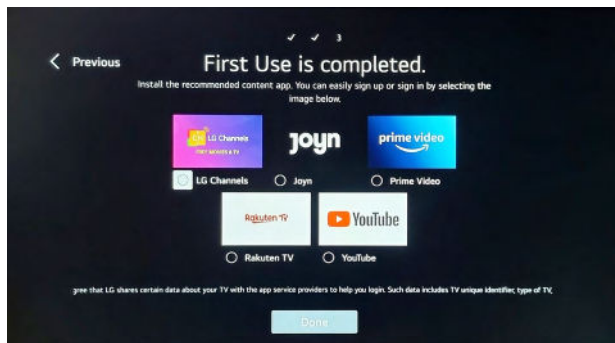

In this step, the desired apps can be installed directly on the TV. Not all apps are pre-installed when the TV is delivered. To do this, select the desired apps and press **[Done]**. For Amazon Prime Video, for example, the screen for linking the customer account starts directly.

The setup is now complete and the TV set will now start in TV mode.

9. HOMESCREEN

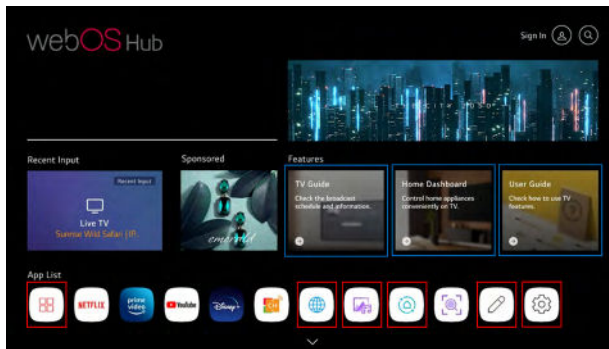

The home screen can be opened from any screen via the [🏠] key on the remote control. This serves as the central hub of the operating system and provides an overview of all installed apps, the content store and all functions of the device.

The most important functions are briefly listed below:

Marked red:

App Store	Access to the Content Store
Web Browser	Web browser with video support
Media Player	Playback of multimedia files (USB stick)
Home Dashboard	Overview of all inputs and Home IoT devices
Editor	Sorting option and deletion of apps
Settings	Open all settings

Marked blue:

Programme Guide	Opening the Programme Guide
Home Dashboard	Overview of all inputs and Home IoT devices
User manual	Detailed digital user manual

i Information – Home IoT devices

The term Internet of Things (IoT) stands for a networked world of smart devices. These IoT devices behave like computers and are networked with other devices locally or via the internet.

Based on LG's operating system, all compatible LG products and our TVs are collected and displayed here in the Home Dashboard.

9.1 Digital user guide

In addition to this printed operating manual, the TV set has a detailed operating manual for the complete operating system under the item "User manual" on the home screen. This is particularly helpful if you do not have the printed operating instructions at hand.

Special topics can be found quickly and easily via the search function. Alternatively, all focal points are sorted alphabetically in the search.

10. RECEPTION

The reception sources DVB-T2, DVB-S2 and DVB-C can be added either directly in the initial setup or alternatively via the settings afterwards (e.g. if the location or the reception type changes).

To do this, go to:

Settings > All settings > General > Channels > Channel search and settings

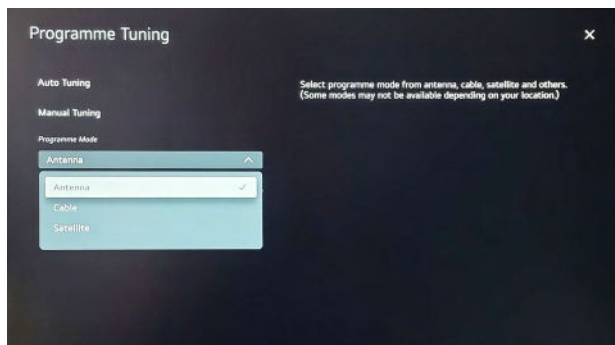

In this menu you now have the options **[Automatic setting]** and **[Manual setting]**. However, we recommend that you always select the automatic setting, unless only certain transponders are to be added.

10.1 DVB-S2 (Satellite) Setup

Step 1 - Selecting the satellite reception mode

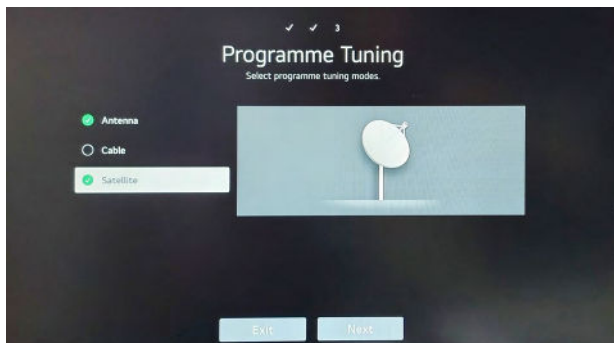

Step 2 - Transmitter setting

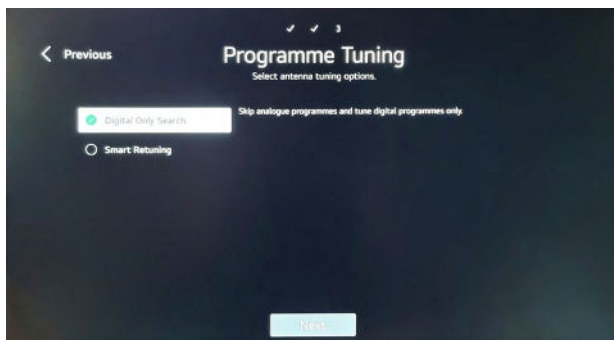

By entering the country beforehand (during the initial installation), the system automatically suggests the most used satellite of the corresponding country.

If you want to store another satellite here, please select **[other providers]** and confirm this with **[Next]**.

Adding other providers

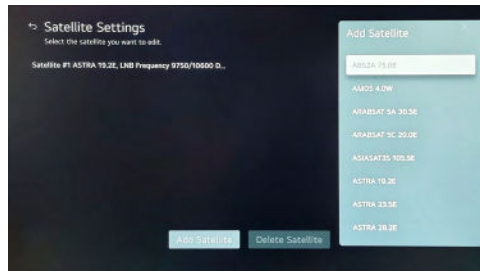
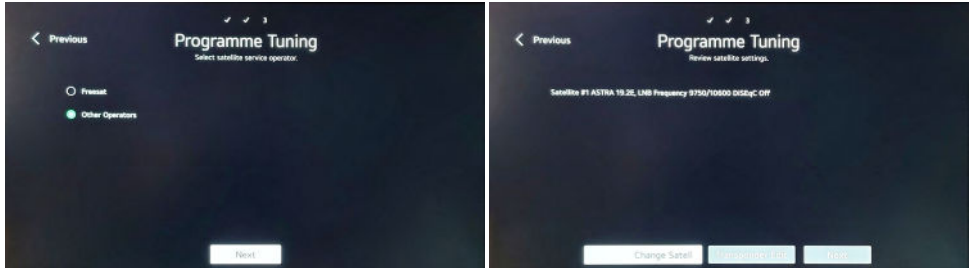

If you have selected **[Other provider]**, the following screen appears. Select the field **[Change satellite]** and add the desired satellite; a list of all available satellites is available.



You can then start the search with the **[Next]** field.

10.2 DVB-T2 (antenna) setup

Step 1 - Selecting the reception type Antenna

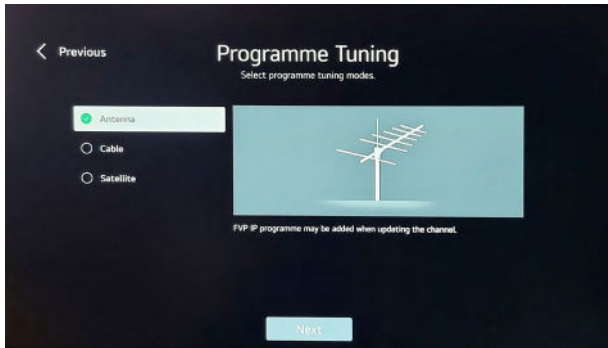

Step 2 - Select whether only digital or also analogue channels are to be searched

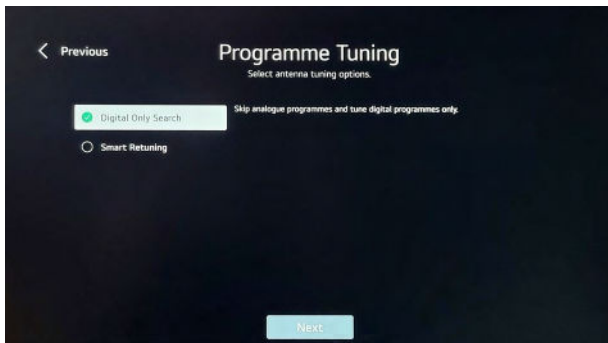

Step 3 - Performing the channel scan



10.3 Switching between reception modes

To switch between the individual reception modes, please proceed as follows. First press the **[LIST]** key on the remote control to open the following selection menu.

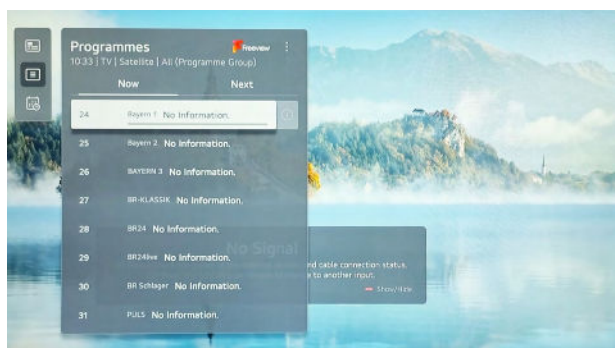

Go to the item **[Channels]** and press the **[***]** key on the remote control. This opens the following filter and you can select between individual reception types. Confirm the selection with **[Done]**.



10.4 Programme Guide, Channels, TV Planner

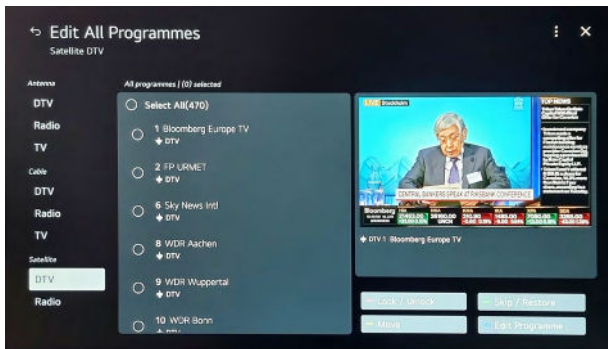

These three functions, which can be accessed via the **[LIST]** key, can be used to plan the entire TV programme.

Programme guide

This is the most important function, which can be accessed directly either via the **[LIST]** key or the **[GUIDE]** key. The programme guide shows you the current TV programme sorted by channel and time.

If you would like to receive more detailed information or a brief description of the respective programme, you can click on it as well as set yourself a corresponding reminder.

Transmitter

This function shows you the currently selected channel list. If you want to change this, please proceed as described in point 10.2 (Switching between reception modes).

TV planner

This function shows you all scheduled reminders for upcoming programmes in an overview.

10.5 Transmitter sorting

The webOS Hub offers two options for sorting channels. This can be done either directly on the TV set or via the "ChanSort" programme on the PC (Windows).

Please note that the channel list cannot be changed, especially in conjunction with CI+ cards, as this is predefined by the TV provider.

10.5.1 Channel sorting on the TV

To do this, press the **[Settings]** key on the remote control and open the following path:

All settings > General > Transmitters > Transmitter manager

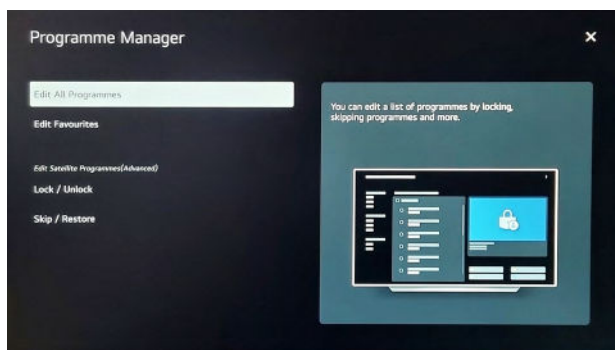

Now the following screen opens, in which you can edit the complete channel list as well as your own favourites list.

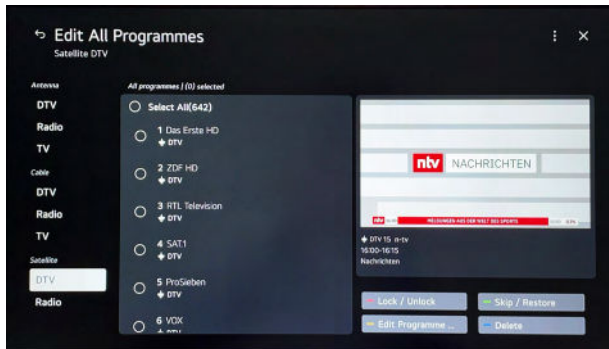

In this case, we have opened the channel list in the DVB-T area. Here, the corresponding channels can now be sorted using the coloured buttons.

10.5.2 Station sorting via ChanSort

The free programme "ChanSort" makes it easy to sort channel lists on the PC instead of on the TV. This makes it much faster and more convenient to create your own channel list or to update the channel list.

"ChanSort" does not require installation and can therefore be started directly after unpacking the archive on the PC (Windows) via the ChanSort.exe contained therein.

When downloading the programme, please make sure to use a reputable source (in our case e.g. from www.chip.de).

To make it as convenient as possible for our customers, we provide ready-made channel lists for the most popular providers on our homepage, which we update at regular intervals. These can then be imported directly via USB.

10.5.3 Exporting / importing channel lists

To be able to export or import a channel list, an empty USB stick (FAT32 formatted) must be connected to the TV.

To do this, press the **[⊗]** key on the remote control and open the following path:

All settings > General > Transmitters > Copy transmitters

If the USB stick has been recognised, it is now displayed first.

In this menu you now have the following options:

TV to USB: Exporting the installed channel list of the TV

USB to TV: Importing the channel list of the USB stick

10.6 HbbTV

The TV set supports the HbbTV (Hybrid Broadcast Broadband TV) standard. This standard enables devices not only to receive the classic TV programme, but also to stream content via the Internet.

For this purpose, the respective broadcaster sends a so-called AI table with a URL to your television. You can then open this with the **red button** on your remote control.

This provides you with additional information about the current programme, the option to restart programmes or to open the broadcaster's media libraries.

This service is channel-dependent and offers different options depending on the channel.

Please note that a sufficient and stable internet connection must be available.

10.7 Displaying the CI+ information

If the system is operated together with a CI+ card, it may be helpful to be able to view the corresponding CI information when activating the card or in support requests. You can find this under the following path:

All Settings > General -> Transmitters -> CI Information

11. INTEGRATED DVD PLAYER (DEPENDING ON MODEL)

i Information

To be able to fully control the DVD drive, an additional remote control is included in the scope of delivery of the corresponding models.

All models with a D in the item number (e.g. SLA-22 DSBW+) have an integrated DVD player.

Overview of buttons & functions



1. **[POWER]** - Switching the DVD drive on/off
2. **[EJECT]** - Eject the DVD
3. **[SETUP]** - Open the settings
4. **[MENÜ]** - Opening the DVD main menu
5. **[GOTO]** - Go to (chapter selection)
6. **[PLAY/PAUSE]** - Play/pause playback
7. **[STOP]** - Stop/terminate playback
8. **[NAVIGATION BUTTONS]** - Navigate as well as rewind
9. **[OK]** - Confirmation of the selection
10. **[KEYPAD]** - Digits 0-9

To open it, please proceed as follows

Step 1

Select the source **[AV]** on the TV set. You can select

this either from the main menu or directly from the remote control with the **[AV]** key.

Step 2

Now press the **[POWER]** button on the remote control of the DVD player.

Step 3

The menu of the DVD player opens. A DVD can then also be inserted into the drive accordingly (Important! Silver side must face the TV!).

Professional tip! Alternatively, you can activate the DVD mode directly during operation by inserting the DVD.

⚠ Important note!

To leave / exit DVD mode again, press the **[POWER]** button on the DVD remote control! If you exit DVD mode directly via the normal remote control, the drive continues to run in the background and only switches automatically to standby mode after approx. 2 hours.

12. MULTIMEDIA FUNCTIONS**12.1 HDMI CEC function**

Since the operating system is LG's webOS Hub, the TV supports SIMPLINK (LG's own CEC control). This allows, for example, a soundbar with HDMI™ input, a console or an Android stick to be connected and controlled via the TV's remote control.

Procedure:

1. Connect the appropriate device to the HDMI™ port on the back of the TV.
2. Press the **[⊗]** button on the remote control and select the following path:

All Settings > General > Devices > HDMI Settings > SIMPLINK (HDMI-CEC) and activate it.

Note: Please use a high-quality connection cable (High Speed HDMI™ cable with Ethernet) for the connection of corresponding devices, which also has the corresponding pin assignment for the exchange of information between both devices.

12.2 Using HDMI ARC

If a corresponding device (e.g. a soundbar) has been connected via HDMI™ and you want to output the sound via it, the audio output source must also be changed.

To do this, press the **[⊗]** key on the remote control and select **[Audio Output]** in the quick selection. Confirm the selection with the **[ENTER]** key. Now the audio output can be changed accordingly to HDMI(ARC) device.

12.3 Connecting Bluetooth® output devices

If you want to connect a Bluetooth® headset or a Bluetooth® loudspeaker to the TV set, you can set this up in two ways.

To do this, go to the settings of the unit with the **[⊗]** key on the remote control.

Variant 1 - Setup via the item [Audio output] (third item from the top)

Now select the selection item **[Bluetooth device]** using the navigation buttons (left/right).

An item with the name **[DEVICE LIST]** appears, select it. The Bluetooth search then opens automatically.

Variant 2 - Open via all settings

Press the  key on the remote control and open the following path:

All settings > Sound > Audio output > Use wireless speaker > Bluetooth device

The Bluetooth® search then opens automatically here as well.

Note! When setting up, please make sure that your headphones or speakers are also in pairing mode so that they can also be found by the TV set.

12.4 Multimedia player

The TV set has an integrated multimedia player that can play back all common formats. To do this, connect the corresponding storage medium to one of the two USB ports and select the Media Player app on the Home screen.

HDD hard disks up to 500 GB or SSD hard disks up to 1 TB are supported.

12.5 Web browser

The web browser of the TV set is very powerful and also supports flash-supported content, which makes it possible to play streaming providers that are not currently available in the content store.

Tip: Create appropriate bookmarks here to be able to open the web pages even faster.

Furthermore, the web browser offers the option of TV view via the 3 dots at the top right. The TV picture is displayed on the left and the browser on the right. This is ideal if you want to search for holiday destinations or routes while watching TV.

12.6 Connecting external peripherals

This generation also supports the connection of external peripheral devices such as a keyboard or mouse. Variants with a 2.4 GHz receiver as well as Bluetooth® variants can be used.

It is recommended to use a product that has been tested for compatibility with TV sets. We currently have the best experience with the following models:

Logitech K360, Logitech K400, Logitech K750

You can change the input language by pressing the language switch key or the right Alt key. Alternatively, this also works by pressing the Ctrl key and the space bar at the same time.

13. GENERAL FUNCTIONS

13.1 Updates

The operating system is designed **exclusively** for OTA updates via the WLAN interface. Updates are made available at regular intervals.

As soon as updates are available (regardless of whether for the operating system or installed apps), the system informs you.

Alternatively, you can also check this manually via the following path:

All Settings > Support > Software Update > Check for Updates

13.2 Settings

The [⊗] key on the remote control can be used to open the settings of the TV set.

All settings are centrally located in this menu.

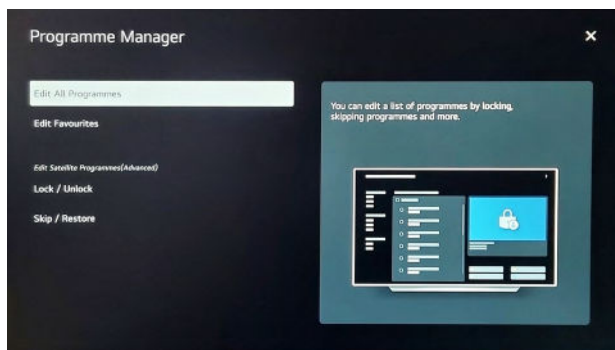

The menu is structured as follows:

Picture mode Select mode: Standard, Basic, Cinema, Sport, Vivid

Sound mode Select mode: Standard, Cinema, Clear Voice, Sport, Music

Audio output	TV loudspeaker (audio playback only via the TV loudspeaker) Bluetooth® Device (Adding Bluetooth® Devices) Mobile device Optical Out Device HDMI (ARC) device Wired headphones Optical output device + TV speaker Wired headphones + TV speakers
Game Optimizer	Only for sources connected via HDMI™.
All settings	Open all other settings
Editing mode	

13.3 Resetting the machine

In the event of problems or the sale of the device, it is advised to reset it accordingly so as not to leave any login data or other personal data on the device.

The corresponding setting can be found via the following path:

All settings > General > System > Reset to factory settings

13.4 Quick Access

All keys on the keypad (1-9) can also be assigned a shortcut .

This can be either an app, a transmitter or even a multimedia input.

1. Start the app or select the channel or input you want to assign.
2. Press and hold down the number key (e.g. key 2) on which the shortcut is to be stored.
3. After a short time, a window appears asking you again whether the shortcut should be added. Confirm this with the **[YES]** field.

Overview and editing of shortcuts

By pressing and holding the **[0]** key, all stored shortcuts can be viewed and edited.

13.5 ThinQ App

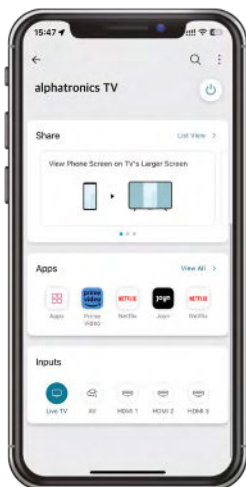
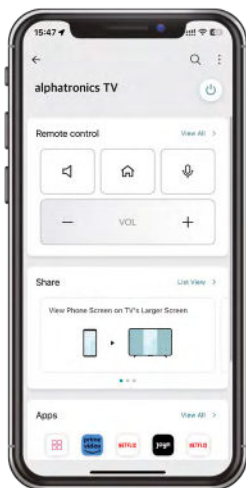

Through the webOS Hub operating system, all our devices support the LG ThinQ app. This is available for all Android and iOS-based devices (via the respective store).

Various functions are available via the app, such as a digital remote control, switching the unit on/off via the smartphone, and sharing the screen, pictures or videos on the TV.

Field: Remote control

Control of the most important unit functions (Mute, Home, Voice, Volume, Keypad, etc.)

Field: Share

- Mirroring your own smartphone screen on the TV set (Important! Some apps cannot be mirrored here for legal reasons!)
- Playing back photos, videos or music on the TV set
- Playing the TV sound on the smartphone

Field: Apps

Opening installed TV Apps

Field: Inputs

Opening the different TV inputs

13.6 Content Store

The Content Store is the webOS Hub's own App Store. The desired apps can be downloaded directly here. Most well-known streaming providers are represented here.

You can access the Content Store via the home screen. Open it via the [🏠] key and then select the "Apps" item.

Important note! To be able to download apps from the Content Store, a corresponding LG account must be created.

13.7 Sharing the smartphone screen

Depending on the smartphone manufacturer and operating system, the screen can be split in different ways. To do this, use either the LG ThinQ app or the device's own service.

With Samsung devices (from Android 12) this works, for example, via Smart View, with Huawei via the "Mirror Share" function.

13.8 Connecting the Windows PC (wirelessly) to the TV set

The TV set offers the possibility to connect a Windows 10/11 laptop or PC wirelessly to the TV set. To do this, press **[Windows] + [K]** from the keyboard of the Windows device.

This opens a window that shows all available displays in the vicinity. Select your alphatronics TV set and connect to it.

The devices do not have to be in the same Wi-Fi network because the connection is established directly between the PC/laptop and the TV.

14. TECHNICAL DATA

Screen	
Display type	LED wide-angle display
Image format	16:9 Widescreen
Viewing angle	178° (H) / 178° (V)
Resolution	Screen size: 19" 1366 x 768 / HD-Ready Screen size: 22", 24", 27", 32", 40" 1920 x 1080 / Full-HD

Interfaces	
Bluetooth® version	5.0
Bluetooth® range	30 m
Bluetooth® Playback Direction	Transmitter or receiver
WLAN	Dual Band (2.4 GHz / 5 GHz)
Reception	
Tuner	Triple Tuner (DVB-S/S2, DVB-T/T2, DVB-C)
Video coding	MPEG-2 / MPEG-4
HEVC standards	H.264 / H.265
TV / Video Systems	PAL, SECAM
Fastscan	Yes
LCN (Logic Channel Numbering)	Yes
HbbTV	Yes
CI+ slot	Yes, standard 2.0 (downward compatible)
Power supply	
Input voltage	9.0 - 32 V DC
Surge protection	Yes
Reverse polarity protection	Yes
Programme memory	
Favourite lists	Yes
max. programme positions: DVB-T/C	500
max. programme positions: DVB-S2	4000
Environmental conditions	
Ambient temperature	-10° to 45
Max. humidity during operation	10 % to 80 % (non-condensing)
Storage temperature	-20° to 60
Max. humidity during storage	5 % to 85 % (non-condensing)
Security	
Security password (default)	0000

15. CLEANING

Do not spray water on the product or bring it into contact with flammable substances (thinner or benzene). There is a risk of electric shock and fire.

When cleaning, make sure that no liquids penetrate the product. The use of cleaning agents containing solvents or aggressive cleaning agents as well as methylated spirits or thinners is prohibited, as they could damage the coating or the surface of the product. Therefore, only clean the product with a soft, lint-free cloth that is not more than slightly damp.

16. LEGAL NOTICES

Licence texts



The terms HDMI, HDMI High-Definition Multimedia Interface, HDMI trade dress and the HDMI Logos are trademarks or registered trademarks of HDMI Licensing Administrator, Inc.

Bluetooth®

The Bluetooth® word mark and logos are registered trademarks owned by Bluetooth SIG, Inc. and any use of such marks by alpatronics is under license.

Apple®, iPhone® and iPad® are trademarks, App Store is a service mark of Apple Inc. registered in the U.S.A. and other countries.

Google, YouTube, other marks are trademarks of Google LLC.

Other names or designations mentioned may be the trademarks or registered trademarks of their respective owners.

Manufacturer information

Dear customer, if you need technical advice and your dealer could not help you, please contact our technical support.

Our technical support is available in German and English.

Please also visit our service page at: <https://www.alpatronics.de/en/support.html>

Disclaimer

alpatronics GmbH does not accept any liability or warranty for damage resulting from improper installation or assembly as well as improper use of the product or failure to observe the safety instructions.

Improvements and changes to these operating instructions - due to printing errors, inaccuracy of the information provided or improvements to the product - may be made by alpatronics at any time and without prior notice. Such

changes will be included in newer editions of these operating instructions or in the online version. All images are for illustrative purposes only and do not necessarily represent the actual device 100% accurately.

Notes on the guarantee

The warranty period begins with the purchase of the unit. Please provide proof of this date with the purchase receipt. Please keep these documents in a safe place. Our warranty service is based on our warranty conditions valid at the time of purchase.

Copyright

These operating instructions are protected by copyright. Any reproduction or reprinting, including excerpts, as well as the reproduction of the illustrations, even in modified form, is only permitted with the written consent of the manufacturer.

Disposal



Notes on environmental protection

From the date of transposition of the European Directives 2012/19/EU and 2006/66/EC into national law, the following applies: Electrical and electronic equipment as well as batteries must not be disposed of with household waste. The consumer is legally obliged to return electrical and electronic equipment as well as batteries at the end of their life to the public collection points set up for this purpose or to the point of sale. Details are regulated by the respective national law. The symbol on the product, the instructions for use or the packaging indicates these regulations. By recycling, material recovery or other forms of recovery of old appliances/batteries, you are making an important contribution to protecting our environment.

i Information - Packaging materia

Packaging and packaging materials are recyclable and should always be recycled. Packaging materials such as foil bags do not belong in children's hands!



FR

Cet appareil,
ses piles
et cordons
se recyclent

À DÉPOSER
EN MAGASIN



OU

À DÉPOSER
EN DÉCHÈTERIE



Points de collecte sur www.quefairedemesdechets.fr
Privilégiez la réparation ou le don de votre appareil !

Simplified declaration of conformity according to RED Directive

alphatronics GmbH hereby declares that the type of radio equipment described complies with Directive 2014/53/EU and the other directives applicable to the product.

The full text of the EU declaration of conformity is available at the following Internet address:

<https://alphatronics.de/de/support/konformitaetserklaerung,83/>

(Please note your corresponding model designation for this).

Information on the transmitting power

	Frequency range	Transmitting power
Bluetooth®	2400 up to 2483.5 MHz	> 10 dBm
WLAN	2400 to 2483.5 MHz	> 20 dBm
	5150 to 5725 MHz	> 20 dBm
	5725 to 5850 MHz	> 20 dBm

(Since frequency channels may differ by country, the user cannot change or adjust the operating frequency. This unit is set according to the regional frequency table).

alpatronics GmbH
Breitengraserstraße 6
90482 Nürnberg

Tel. +49 (0) 911 21 65 54-0
Fax +49 (0) 911 21 65 54-65

alpatronics-Service:

Tel. +49 (0) 911 21 65 54-45
E-Mail: service@alpatronics.de

E-Mail: info@alpatronics.de
Web: www.alpatronics.de